

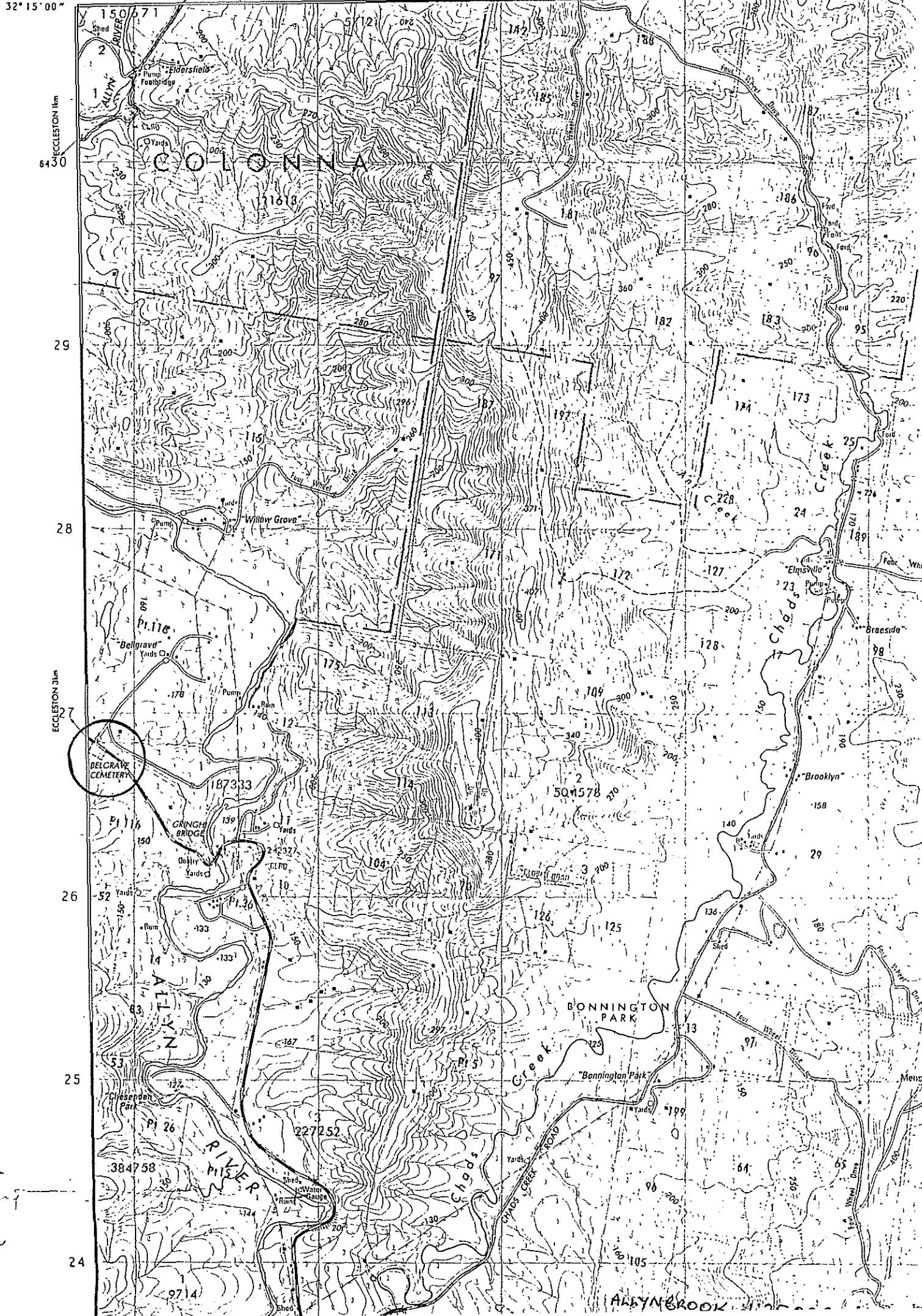

DUNGOG HERITAGE STUDY Perumal, Wrathall & Murphy Pty. Ltd. in association with Cameron McNamara		Item A48	Photograph BW 2/11A, 12A C 2/Nil
Location 3km south of Eccleston on the west side of the road on the slope of a hill		Precinct Date 16/1/87	
Title Description Belgrave cemetery		Survey By AB	
Description A cemetery by itself in a field about 30-50 headstones of a late 19thc to mid 20thc style			
History:			
Significance: Regional and local			
Alterations/Integrity:			
Condition: <input type="checkbox"/> Good <input type="checkbox"/> Fair <input type="checkbox"/> Poor	Style:	Street Context:	
Current Use: Original use: Cemetery	Period: <input checked="" type="checkbox"/> Pre-1890 <input checked="" type="checkbox"/> 1915-45 <input checked="" type="checkbox"/> 1890-1915 <input checked="" type="checkbox"/> 1945- Actual date (if known)	<input type="checkbox"/> Positive contribution <input type="checkbox"/> Neutral <input type="checkbox"/> Out of Character Possible remedies	
Current listings: <input type="checkbox"/> AHC <input type="checkbox"/> HC <input type="checkbox"/> NT <input type="checkbox"/> RAIA/Other			
Thematic context Churches and cemeteries			
References: Nil			
*			

	Item
Existence on Early Plans, Maps or Drawings	Architect
	Builder
	Original Owner
Shown on Early Photographs	
	
Location Map	Sketch

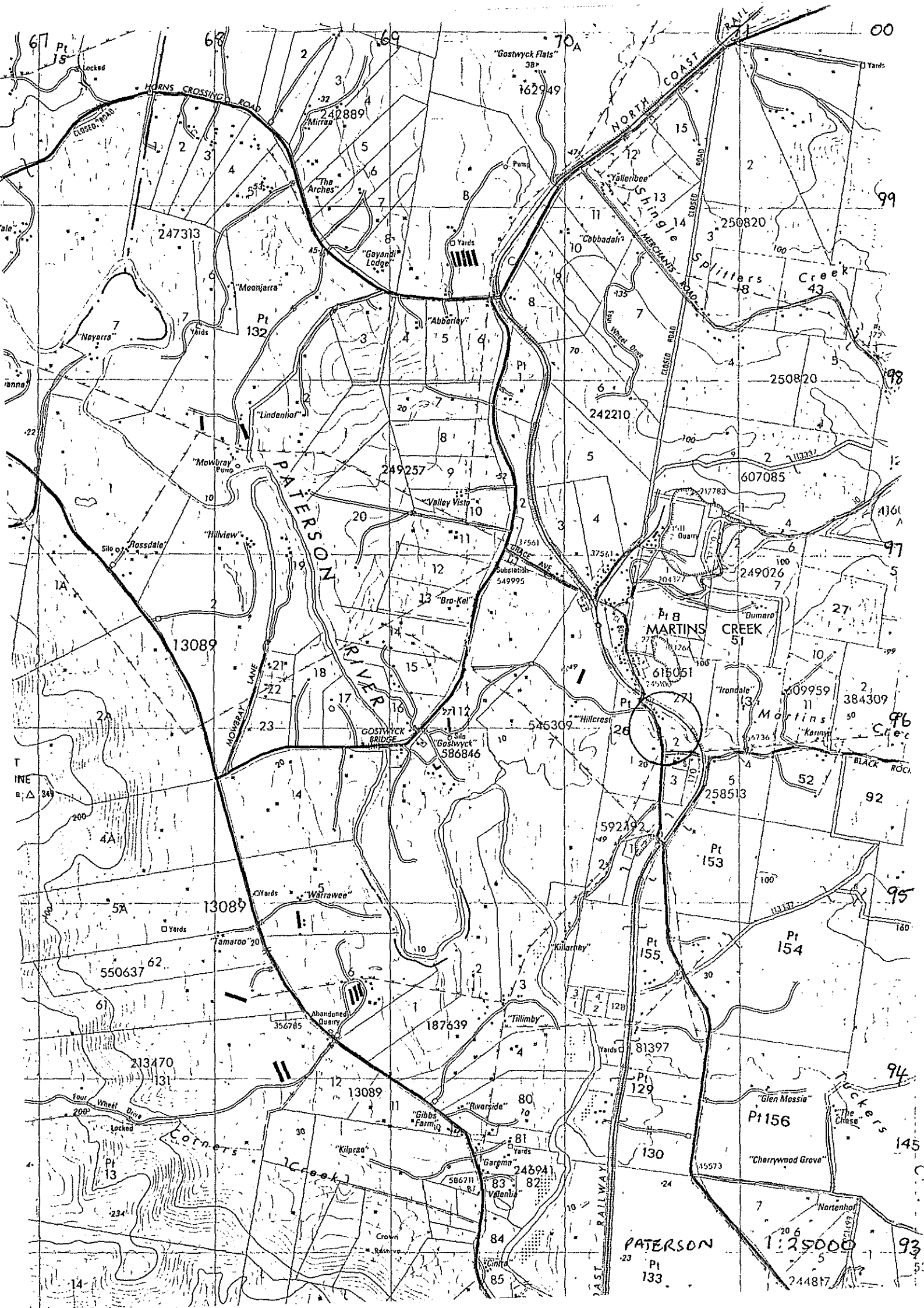

DUNGOG HERITAGE STUDY Perumal, Wrathall & Murphy Pty. Ltd. in association with Cameron McNamara		Item A49	Photograph Nil
Location Martin's Creek, next to the North Coast Railway		Precinct Date 17/1/87 Survey By AB	
Title Description St. James Anglican Church			
Description Timber church on the west side of the road through Martin's Creek to Paterson.			
History:			
Significance:			
Regional and local			
Alterations/Integrity:			
Condition: <input checked="" type="checkbox"/> Good <input type="checkbox"/> Fair <input type="checkbox"/> Poor		Style:	
Current Use: Original use:		Period: <input type="checkbox"/> Pre-1890 <input type="checkbox"/> 1915-45 <input type="checkbox"/> 1890-1915 <input type="checkbox"/> 1945- Actual date (if known)	
		Street Context: <input type="checkbox"/> Positive contribution <input type="checkbox"/> Neutral <input type="checkbox"/> Out of Character Possible remedies	
Current listings: <input type="checkbox"/> AHC <input type="checkbox"/> HC <input type="checkbox"/> NT <input type="checkbox"/> RAIA/Other		For photo see backsheet & section	
Thematic context Churches and cemeteries			
References: Nil			
*			



DUNGOG HERITAGE STUDY Perumal, Wrathall & Murphy Pty. Ltd. in association with Cameron McNamara		Item A50	Photograph BW 2/27A C 2/24;28
Location Summer Hill. 1km off the Summer Hill Road, west of the Paterson River		Precinct Date 17/1/87 Survey By AB	
Title Description Summer Hill church and cemetery			
Description Sacred Heart Catholic Church. Overlooking a loop of the Paterson River. The entrance faces the river. Built 1913, of brick with a timber ceiling. Church and graves face the river. Many Irish names - Ryan, McEwen, McKeown, Brodie, Casey etc. History: Replaces a church from 1842-1912.			
Significance: Regional and local			
Alterations/Integrity:			
Condition: <input checked="" type="checkbox"/> Good <input type="checkbox"/> Fair <input type="checkbox"/> Poor	Style:	Street Context:	
Current Use: Original use: Church and cemetery	Period: <input type="checkbox"/> Pre-1890 <input type="checkbox"/> 1915-45 <input type="checkbox"/> 1890-1915 <input type="checkbox"/> 1945- Actual date <u>1913</u> (if known)	<input type="checkbox"/> Positive contribution <input type="checkbox"/> Neutral <input type="checkbox"/> Out of Character Possible remedies	
Current listings: <input type="checkbox"/> AHC <input type="checkbox"/> HC <input type="checkbox"/> NT <input type="checkbox"/> RAIA/Other			
Thematic context Churches and cemeteries			
References: Nil			
*			

151° 30' 00"

SINGLETON 44km GRESFORD 10km

GRESFORD 13km

PATERSON 1:25,000

360

617

612

63

32° 30' 00"

03

02

01

LK

LJ

99

98

97

96

LEES MOUNTAIN

"Glen Albyn"

"Marys Mount"

FISHERS HILL

"Loretta"

KEALYS BIGHT

SUMMER HILL

PATERSON RIVER

4900

Run

8

Pt 20

24602

ROAD

24602

Pt 21

Yards

11

4900

51

2

518282

50

Stanley Grange

11

Lennoxton

550803

117

12

100

Gully

7

Rodneys

Woodlands

304

9524

200

300

200

13

250

67

300

MOUNT GEORGE

George 455

134

Crown Reserve

133

400

132

MOONABUNG RANGE

300

300

300

200

200

200

200

200

200

200

200

200

"Glen Vista"

169158

24602

Pt 4

3

184432

3

107

21

97

50

95

60

57

67

132

133

400

300

300

300

300

300

300

300

300

300

300

300

300

300

Creek

22

18

Sugarloaf

97

50

95

60

57

67

132

133

400

300

300

300

300

300

300

300

300

300

300

300

300

300

300

300

167010

2

Yards

169157

5

100

23

120

KEALYS

SUGARLOAF

49

50

95

60

57

67

132

133

400

300

300

300

300

300

300

300

300

300

300

300

300

300

228307

100

200

300

400

500

600

700

800

900

1000

1100

1200

1300

1400

1500

1600

1700

1800

1900

2000

2100

2200

2300

2400

2500

2600

2700

2800

2900

3000

3100

3200

3300

3400

3500

3600

3700

3800

3900

4000

4100

4200

4300

4400

4500

4600

4700

4800

4900

5000

5100

5200

5300

5400

5500

5600

5700

5800

5900

6000

6100

6200

6300

6400

6500

6600

6700

6800

6900

7000

7100

7200

7300

7400

7500

7600

7700

7800

7900

8000

8100

8200

8300

8400

8500

8600

8700

8800

8900

9000

9100

9200

9300

9400

9500

9600

9700

9800

9900

10000

10100

10200

10300

10400

10500

10600

10700

10800

10900

11000

11100

11200

11300

11400

11500

11600

11700

11800

11900

12000

12100

12200

12300

12400

12500

12600

12700

12800

12900

13000

13100

13200

13300

13400

13500

13600

13700

13800

13900

14000

14100

14200

14300

14400

14500

14600

14700

14800

14900

15000

15100

15200

15300

15400

15500

15600

15700

15800

15900

DUNGOG HERITAGE STUDY Perumal, Wrathall & Murphy Pty. Ltd. in association with Cameron McNamara		Item A51	Photograph BW Nil C 2/21-23
Location Vacy . On the west side of the road from Gresford.		Precinct Date 17/1/87 Survey By AB	
Title Description Saint John's Anglican church, Vacy			
Description Red brick with asbestos slates. Apsidal altar area. Has a columbarium outside. A very beautiful church inside. Is all red cedar fittings and cedar large chairs at altar. Cedar roof. Has a carved Roll of Honour for WW I with Australiana motif of gumnuts and gumleaves. History: Dedicated 8/12/1887.			
Significance: State and regional and local			
Alterations/Integrity:			
Condition: <input checked="" type="checkbox"/> Good <input type="checkbox"/> Fair <input type="checkbox"/> Poor	Style:	Street Context:	
Current Use: Original use: Church	Period: <input type="checkbox"/> Pre-1890 <input type="checkbox"/> 1915-45 <input type="checkbox"/> 1890-1915 <input type="checkbox"/> 1945- Actual date <u>Dedicated 1887</u> (if known)	<input type="checkbox"/> Positive contribution <input type="checkbox"/> Neutral <input type="checkbox"/> Out of Character Possible remedies	
Current listings: <input type="checkbox"/> AHC <input type="checkbox"/> HC <input checked="" type="checkbox"/> NT <input type="checkbox"/> RAIA/Other			
Thematic context Churches and cemeteries			
References: <u>Thematic History</u> : 96; 119			
*			

VACY

STT JOHN'S CHURCH

(Town or District)

Post Code
Local Govt AreaAuthor of
ProposalDate of
Proposal

(Name or Identification of Proposed Listing)

(Address or Location)

Suggested
Listing Category
RECORDED

Bibliography

Owner and Address

Committee
(Trust Use)
SEE OVERCouncil
(Trust Use)
11/2/74

Description

Briefly cover the points on the following check list where they are relevant and within your knowledge.

Style **brick, asbestos slates**
 Construction **chancel, vestry, porch**
 Use **dedicated 8/12/1887 by Canon Selwyn**

Architect/s

Builder/s

Date of

Construction

Present

Condition

ry

Owners

Boundaries

of proposed

listing

Reasons for listing

- c 21 - church
 22 - inside church - timber ceiling
 23 - interior showing timber panelling

Sketch plan and photos
 Attach additional photos
 if any.



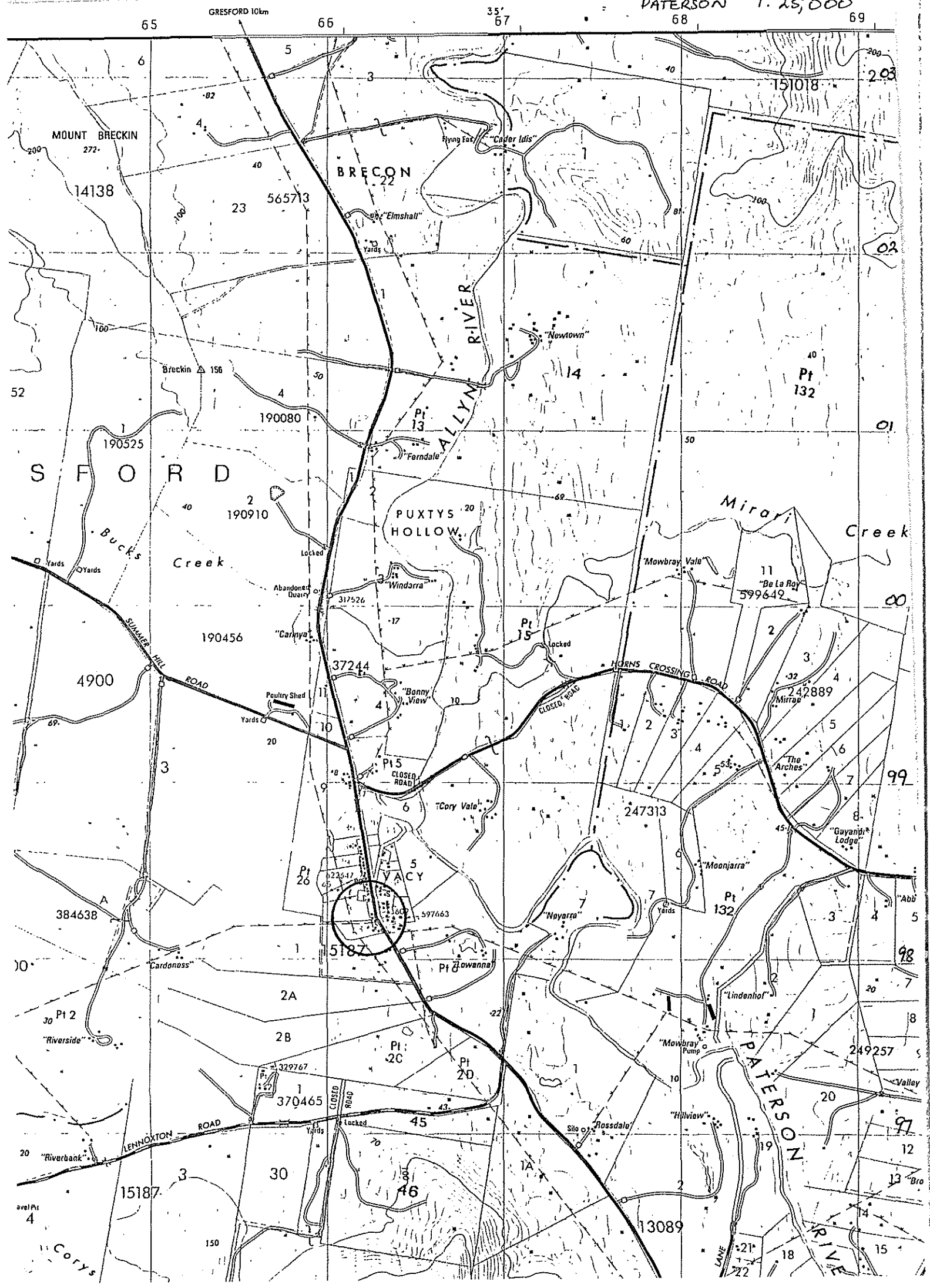

DUNGOG HERITAGE STUDY Perumal, Wrathall & Murphy Pty. Ltd. in association with Cameron McNamara		Item A52	Photograph BW 3/1 C 35
Location Paterson, Webber's Creek Road.		Precinct Date 17/1/87	
Title Description Paterson General Cemetery.		Survey By AB	
Description A cemetery with about 100 headstones, and a columbarium. Out from the town along Webber's Creek road. Photo taken looking west. History:			
Significance: Regional and local			
Alterations/Integrity:			
Condition: <input checked="" type="checkbox"/> Good <input type="checkbox"/> Fair <input type="checkbox"/> Poor	Style:	Street Context:	
Current Use: Cemetery Original use:	Period: <input type="checkbox"/> Pre-1890 <input type="checkbox"/> 1915-45 <input checked="" type="checkbox"/> 1890-1915 <input checked="" type="checkbox"/> 1945- Actual date (if known)	<input type="checkbox"/> Positive contribution <input type="checkbox"/> Neutral <input type="checkbox"/> Out of Character Possible remedies	
Current listings: <input type="checkbox"/> AHC <input type="checkbox"/> HC <input type="checkbox"/> NT <input type="checkbox"/> RAIA/Other			
Thematic context Churches and cemeteries			
References: Nil			
*			

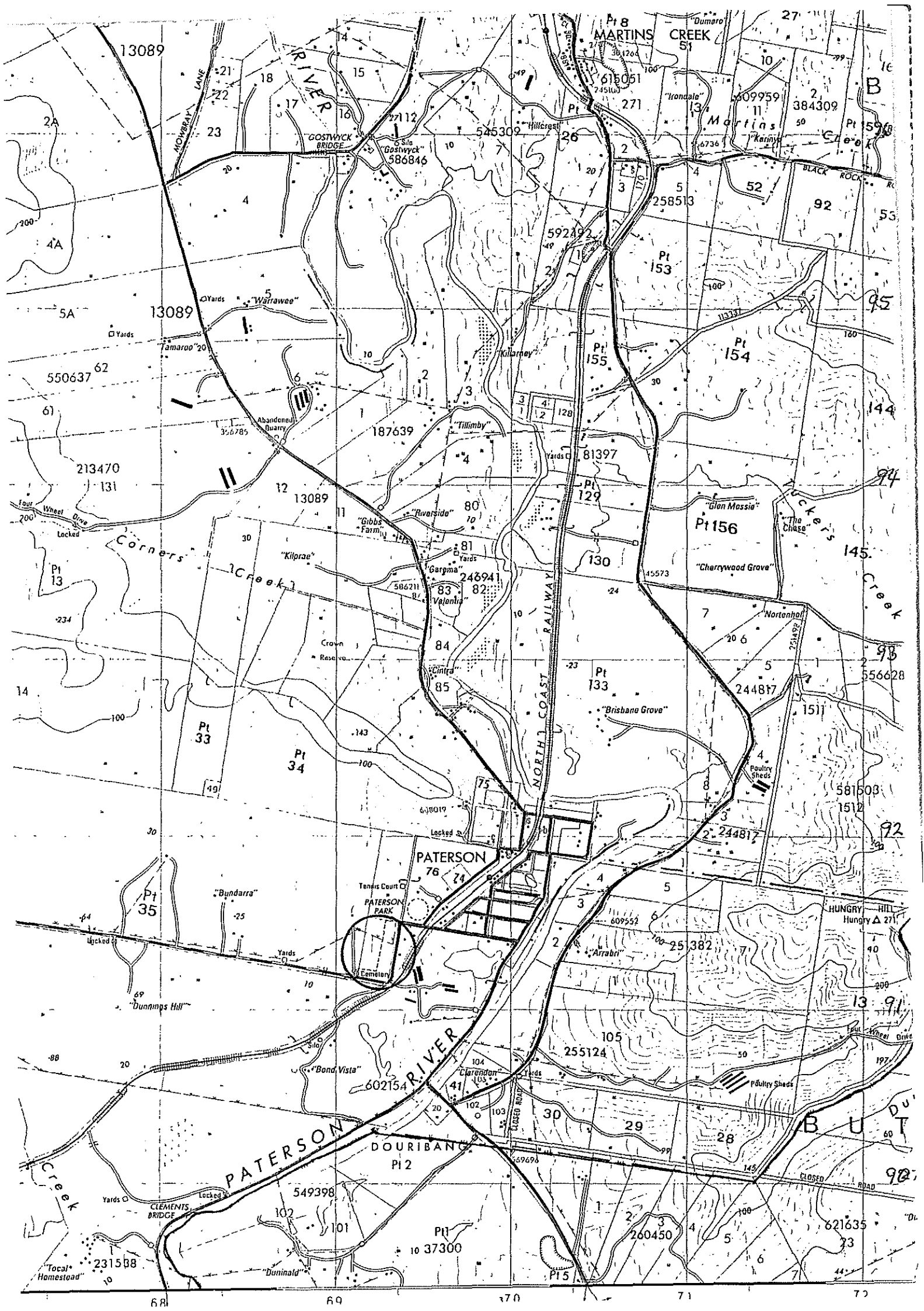

DUNGOG HERITAGE STUDY Perumal, Wrathall & Murphy Pty. Ltd. in association with Cameron McNamara		Item A53	Photograph BW 3/8 C 3/4
Location Clarence Town General Cemetery. c. 1 km to the west of the town on Cemetery Road.		Precinct Date 17/1/87	
Title Description Clarence Town General Cemetery		Survey By AB	
Description On flat ground next to Stony Creek. Dense vegetation lines the Creek. Monuments date from the 1860s and there is a very good collection of 1860s to 1880s stones. (See NT Listing Proposal for details) History:			
Significance: Regional and local			
Alterations/Integrity:			
Condition: <input checked="" type="checkbox"/> Good <input type="checkbox"/> Fair <input type="checkbox"/> Poor		Style:	
Current Use: Cemetery Original use:		Period: <input checked="" type="checkbox"/> Pre-1890 <input checked="" type="checkbox"/> 1915-45 <input checked="" type="checkbox"/> 1890-1915 <input checked="" type="checkbox"/> 1945- Actual date (if known)	
Current listings: <input type="checkbox"/> AHC <input type="checkbox"/> HC <input checked="" type="checkbox"/> NT <input type="checkbox"/> RAIA/Other		Street Context: <input checked="" type="checkbox"/> Positive contribution <input type="checkbox"/> Neutral <input type="checkbox"/> Out of Character Possible remedies	
Thematic context Churches and cemeteries			
References: National Trust Listing Proposal			
*			

CLARENCE TOWN	CEMETERY CONSERVATION AREA GENERAL CEMETERY	NSW Topographic 1st Ed 1:25000 "CLARENCE TOWN" 9232-1-N 835/936	
Town, District or Location Postcode 2321	Name or Identification of Listing		
Author of C Burke, M Proposal Lehaney, G Gibbons, I Wood-	Region HUNTER		
Date of Proposal Bradley 18-7-83	Local Govt. Authority DUNOGG SHIRE COUNCIL		
Suggested Listing Category CLASSIFIED	Responsible Authority DUNOGG SHIRE COUNCIL	Location & boundaries (incl. map ref.)	
Committee (Trust Use) CC		Area (ha.) 2	Approx. No. Burials 450+
Council (Trust Use)			

Description Briefly cover the points on the following check list where they are relevant and within your knowledge.
(Attach appendices if insufficient space)

☒ Location & Surroundings, Layout, Landscape, Structures, Monuments/styles, Burials of significance, Earliest known burial date

The cemetery is sited on flat ground adjacent to a meandering creek. Dense vegetation lining the creek forms a visual boundary to the south east. The grid layout is made more interesting with 2 gravel roads delineating areas (one curvilinear). Gravestones predominantly face east but a number face north and south. Burning and weed killer has been used to control weed growth. This process has damaged some monuments and destroyed some timber picket surrounds. Monuments date from the 1860s and there is very good collection of 1860s-1880s stones (they appear to be of earlier design), most are carved from Ravensfield sandstone by Browne (Maitland).

Monuments of note include:

William Wilding d 1867 - handsome sandstone monument with columns and draped urn - has been repaired with bronze dowels. David Johnston d 1876 - stylish very large headstones with columns and draped urn in bas-relief. Many inscriptions have been painted. Numerous glazed Victorian ceramic tiles are present.

Reasons for Listing

A large, early cemetery, containing distinctive and major local family monuments. Unusual for its extent the cemetery forms an attractive setting on the outskirts of the town.

Roll 3 B+W 8 } General Cemetery
C 4 }

Bibliography

See over for photos and map showing boundaries

GENERAL COMMENT:

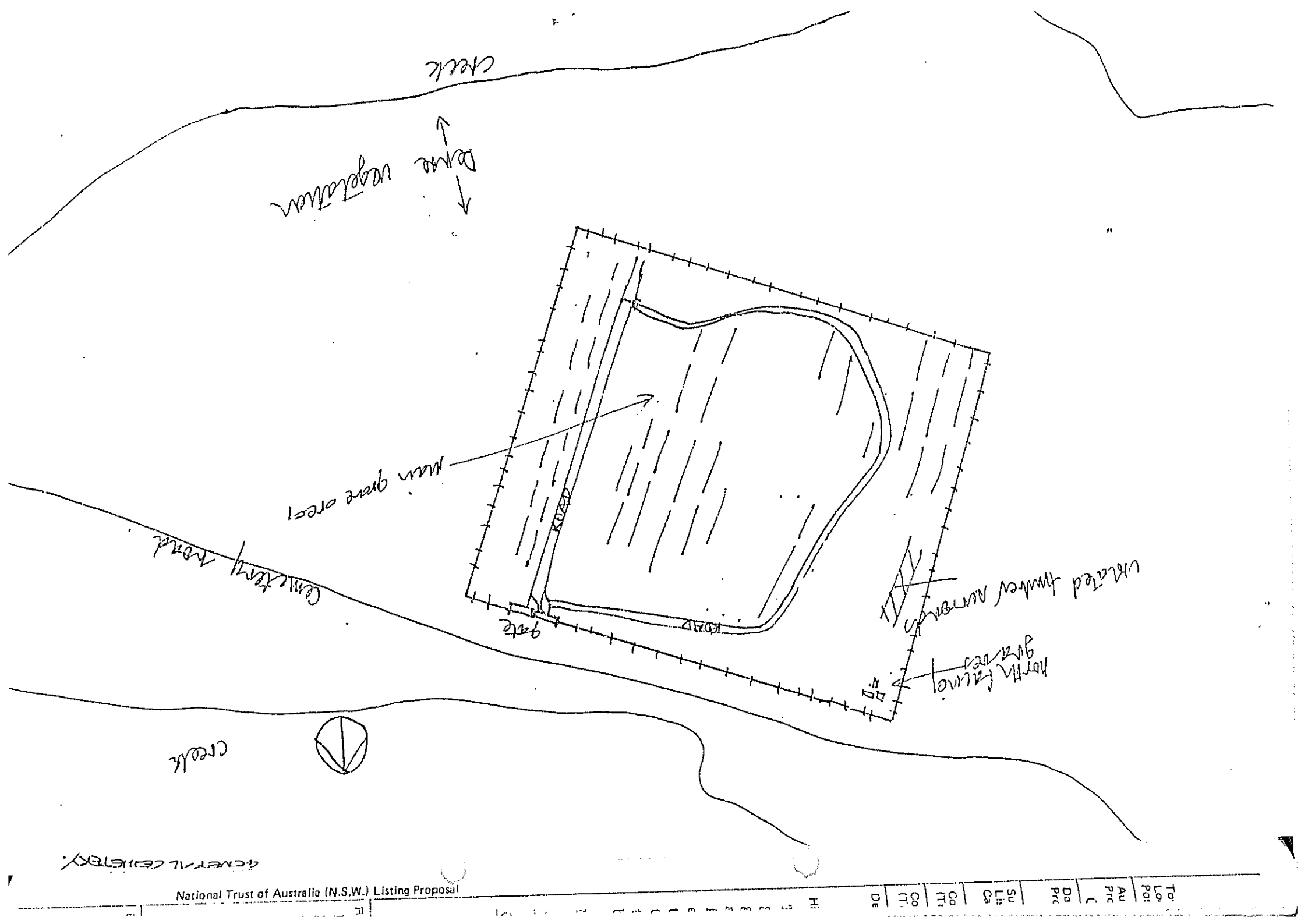

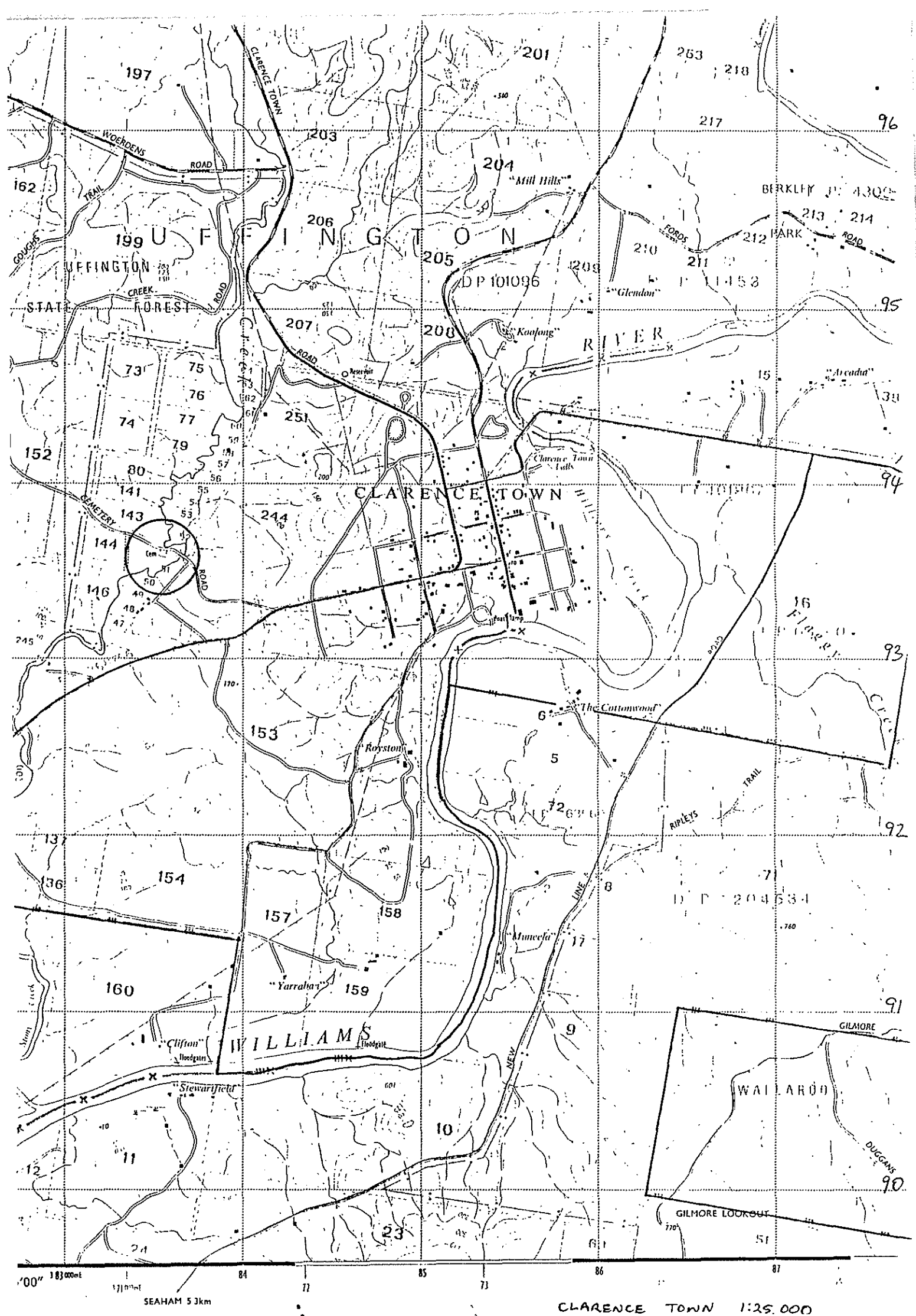

DUNGOG HERITAGE STUDY Perumal, Wrathall & Murphy Pty. Ltd. in association with Cameron McNamara		Item A54	Photograph BW 2/36A C 2/34
Location Paterson. Duke Street, near Prince Street, near Tucker Park.		Precinct Date 17/1/87	
Title Description Graveyard in St. Paul's Anglican Church		Survey By AB	
Description Graveyard behind the church. On NT Listing Proposal it is described as "an exceptional example of a church graveyard" The church was consecrated in November 1845. It has a "country style" flat wrought iron grave fence, among other styles. History: See NT Listing proposals.			
Significance: Regional and local			
Alterations/Integrity:			
Condition: <input checked="" type="checkbox"/> Good <input type="checkbox"/> Fair <input type="checkbox"/> Poor	Style:	Street Context: <input checked="" type="checkbox"/> Positive contribution <input type="checkbox"/> Neutral <input type="checkbox"/> Out of Character Possible remedies	
Current Use: Churchyard Original use:	Period: <input checked="" type="checkbox"/> Pre-1890 <input checked="" type="checkbox"/> 1915-45 <input checked="" type="checkbox"/> 1890-1915 <input checked="" type="checkbox"/> 1945- Actual date (if known)	Possible remedies	
Current listings: <input type="checkbox"/> AHC <input type="checkbox"/> HC <input checked="" type="checkbox"/> NT <input type="checkbox"/> RAIA/Other			
Thematic context Churches and cemeteries			
References: <u>Thematic History</u> :61;119. NT Listings			
*			

Town, District or Location Postcode 2420	CEMETERY CONSERVATION AREA		NSW Topo Map 1:25,000 1st Ed. 'Paterson' 9232-IV-N 703/300	
	PATERSON ST PAULS CHURCH OF ENGLAND CEMETERY			
Author of Proposal R. Mackay	Name or Identification of Listing		Region HUNTER	
Date of Proposal 12.9.83	Local Govt. Authority DUNGOG SHIRE COUNCIL		80m x 40m (excluding Church)	
Suggested Listing Category CLASSIFIED	Responsible Authority ANGLICAN CHURCH PARISH OF PATERSON 22 DULCE STREET PATERSON		Location & boundaries (incl. map ref.)	
Committee (Trust Use) C.C.			Area (ha.) 3.2	Approx. No. Burials 250+
Council (Trust Use)				
Description	Briefly cover the points on the following check list where they are relevant and within your knowledge. (Attach appendices if insufficient space)			

History Location & Surroundings, Layout, Landscape, Structures, Monuments/styles, Burials of significance, Earliest known burial date

St Paul's cemetery has an outstanding array of early monuments covering both popular and unusual styles from the second half of the nineteenth century. It lies behind the church overlooking a cleared common and the river to the East and is bordered by olive, fig and silky oak trees. Few traditional plantings survive other than oxalis and the occasional bulb. More common are pampas grass, dandelion and a prolific range of weeds. Maintenance appears minimal - growth is possibly kept in check by the large number of visitors the site receives. (It is a local tourist attraction.) The layout shows definite development with the earliest monuments near the church and later ones towards the river. Numerous examples of ironwork occur: simple surrounds, a flat wrought design, assorted combinations of cast and wrought types. The grave of Robert Andrews (1889) includes a cast iron easel with wreath and "in memoriam". Early monuments demonstrate a remarkable range in sandstone examples: simple Georgian tablets and footstone, naive angels, sarcophagi, doves, scrolls, bevelling and floral motifs. The later section includes Gothic tablets, urns, columns and obelisks in marble and granite. An enormous amount of early biographical data is documented on the headstones, many of which mark the graves of early settlers. One additional feature is a number of graves marked by headstones on which the inscription faces outside the surround, away from the footstone.

Notable monuments:

John Alford and Family 21.8.1884. Sandstock brick altar with sandstone tabletop surmounted by cubic sandstone pillar inscribed with verse itself topped by ornate open urn.
William Arnold 26.10.1875 (Drowned in flood of Paterson River) Medieval sarcophagus in sandstone with stylized cross. 19 years Speaker of Assembly. (cont'd over)

Reasons for Listing

This is an exceptional example of a church graveyard in use until the end of the nineteenth century. The sandstone monuments are of a fine quality sculpture and many retain original iron surrounds. The density of monuments attests to the absence of vandalism and the continuous care which have left this cemetery as a rare example of an intact country church cemetery.

Roll 2 B+W: Neg. 36A - Cemetery + Church
C: Shot 34 - " "

Bibliography

See over for photos and map showing boundaries

Description (continued)

Adam Mather 10.7.1870 Sandstone tablet with widow lamenting her loss at urn
 William Miller 13.12.1849 Sandstone headstone with inscription facing away from footstone.
 Elizabeth Mary Dunn 15.10.1853 Sandstone headstone with upper area ornamented by hourglass, three-masted ship and anchor, and ornate iron surround. Inscription faces away from footstone. Also John Henry Dunn d May 30, 1881

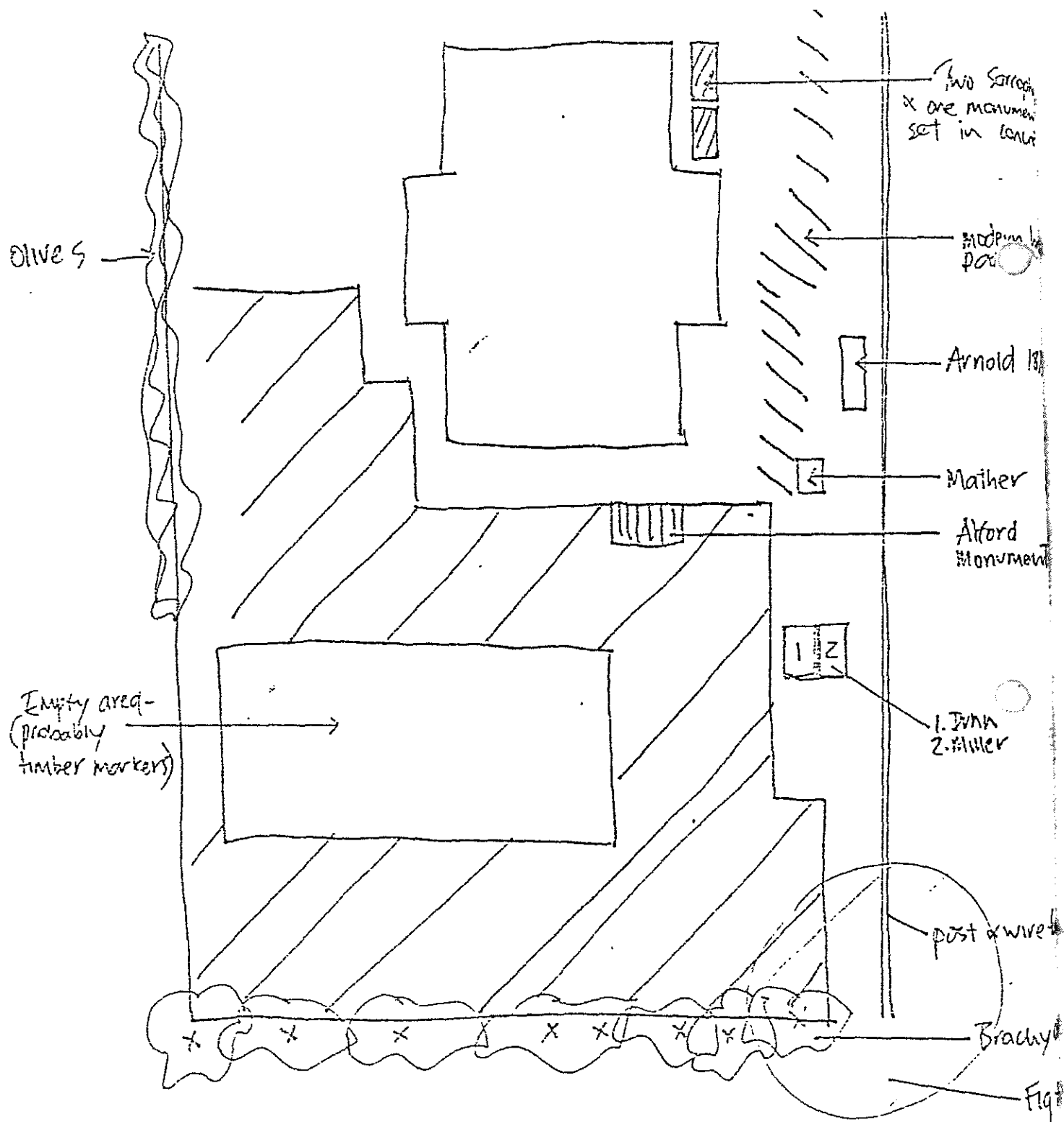

St Pauls C of E Cemetery
 Paterson

PATERSON

ST. PAUL'S CHURCH OF ENGLAND
AND GRAVEYARD

PRINCE STREET

Town or District)

Post Code 2421 Dungog
Local Govt Area Shire CclAuthor of
Proposal W.G. HUREDate of
Proposal 15/3/76Suggested
Listing
Category CLASSIFIEDCommittee
(Trust Use) SEE OVER
HBCCouncil
(Trust Use) APPROVED CL
31/5/76

(Name or Identification of Listing)

Bibliography

Hunters River - C. Mitchell
Churches of Romance & History - C of
E Hist. Socy Journal Vol 16 No. 1,
March 1971.

(Address or Location)

Owner and Address

Church of England,
Diocese of Newcastle.Advised 17/6/76
Copy to Dungog Council

Description

Briefly cover the points on the following check list where they are relevant and within your knowledge.

Style is Early Gothic Revival, constructed of stone with galvanised iron roof. Nave porch and vestry, rubble stone interior with walls rendered. Unusual Tudor windows with timber tracery, wainscot to nave. Entrance door to two panels, fielded, with large key in door. Cemetery surrounding church of considerable historic interest. Consecrated on November 27th, 1845 St. Paul's Church and adjoining graveyard by Bishop Broughton. Built mainly at the expense of the first incumbent, Rev. James Jennings-Smith, who arrived in Sydney with his wife and ten children on 29th September, 1839. Large window in Church has coat of arms of Jennings-Smith. Interior has cedar pews, open-backed with book rest, panelled dado, timber pulpit. Present condition good, boundaries of listing - present Church of England, land and adjoining graveyard.

Reasons for listing

Simple and delightful early Gothic Revival Church with adjoining graveyard containing gravestones of considerable historic significance.

Arch plan and photos
Attach additional photos
any.



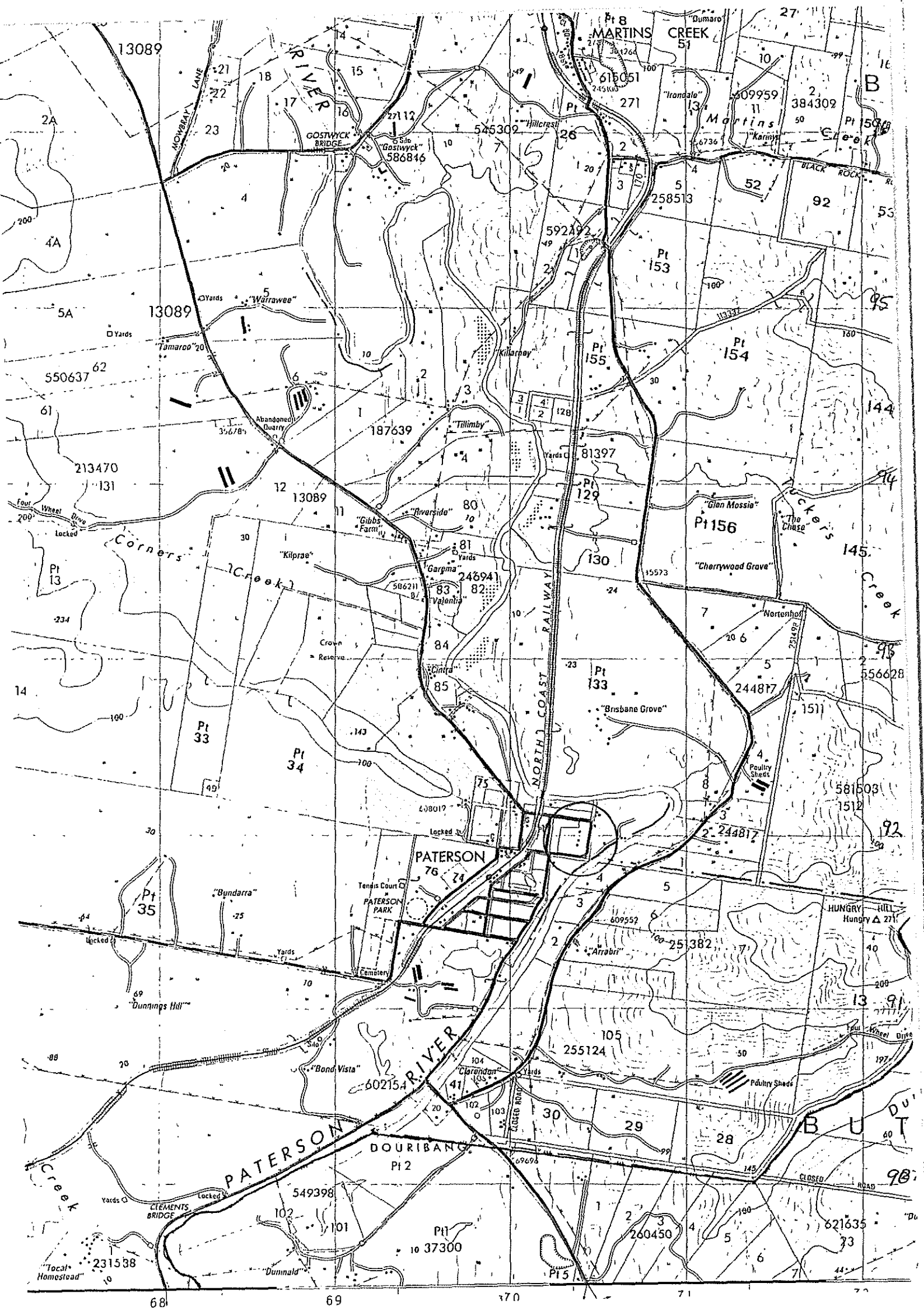

DUNGOG HERITAGE STUDY Perumal, Wrathall & Murphy Pty. Ltd. in association with Cameron McNamara		Item A55	Photograph BW 3/13, 14 C 3/7
Location Clarence Town. Corner of Grey Street and Queen Street.		Precinct Date 17/1/87 Survey By AB	
Title Description Headstones at St. John the Evangelist			
Description Church of England Church. A group of three headstones to the Holmes family, 1858, 1860, and 1869 located between the brick church and the wooden church hall. One stone lying on thr ground under a tree to Emma Ikin 185? aged 9 years History:			
Significance: Regional and local			
Alterations/Integrity:			
Condition: <input checked="" type="checkbox"/> Good <input type="checkbox"/> Fair <input type="checkbox"/> Poor	Style:	Street Context: <input checked="" type="checkbox"/> Positive contribution <input type="checkbox"/> Neutral <input type="checkbox"/> Out of Character Possible remedies	
Current Use: Headstones Original use:	Period: <input checked="" type="checkbox"/> Pre-1890 <input checked="" type="checkbox"/> 1915-45 <input checked="" type="checkbox"/> 1890-1915 <input checked="" type="checkbox"/> 1945- Actual date (if known)		
Current listings: <input type="checkbox"/> AHC <input type="checkbox"/> HC <input type="checkbox"/> NT <input type="checkbox"/> RAIA/Other			
Thematic context Churches and cemeteries			
References: Nil			
*			

			
Existence on Early Plans, Maps or Drawings			
Shown on Early Photographs			
Location Map	Sketch		

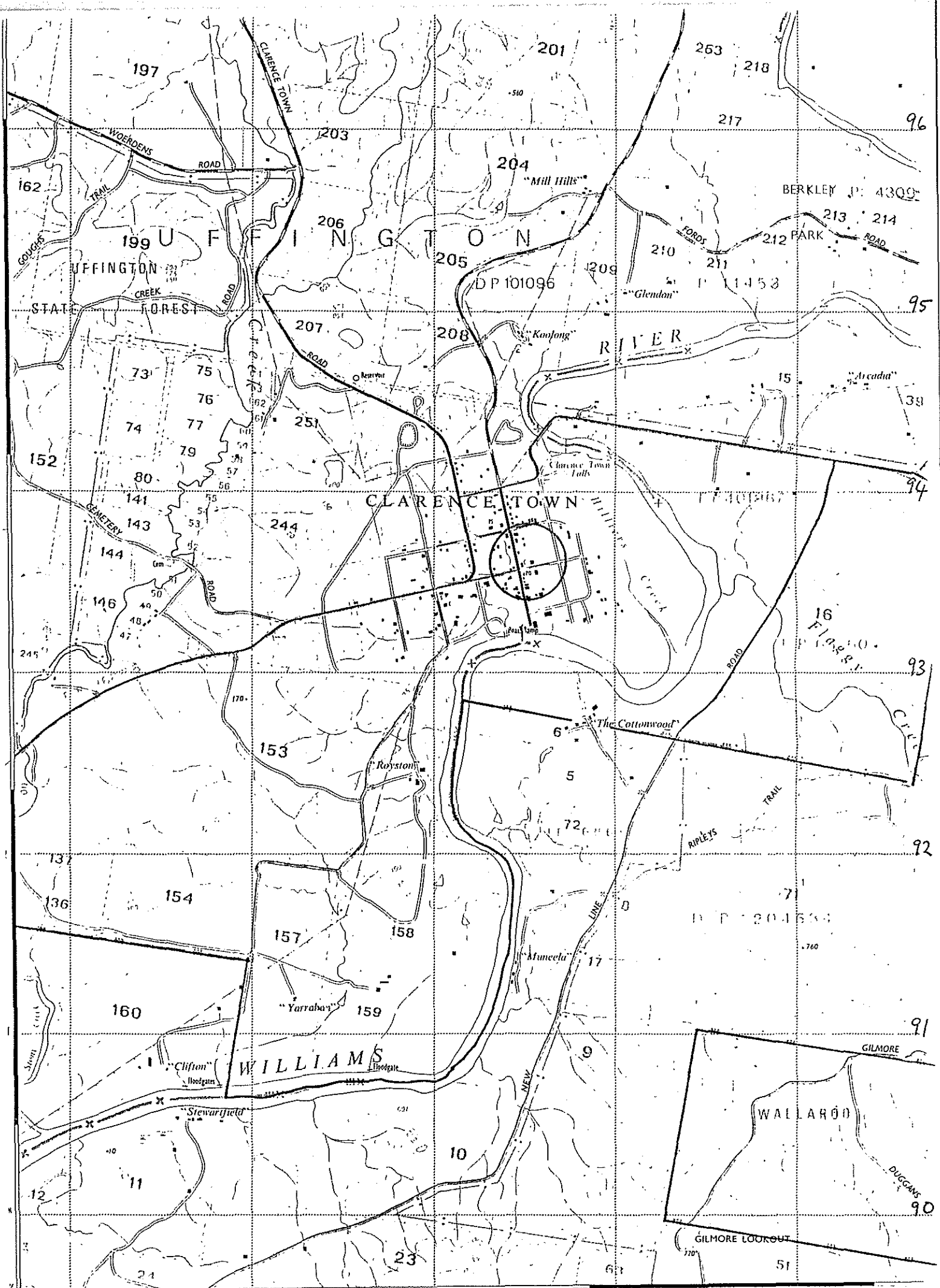

DUNGOG HERITAGE STUDY Perumal, Wrathall & Murphy Pty. Ltd. in association with Cameron McNamara		Item A56	Photograph BW 1/12 C 1/12
Location East bank of Allyn River at Allynbrook. Just opposite the church and cemetery.		Precinct Date 15/1/87	
Title Description Quarry for stone for St. Marys on Allyn		Survey By AB	
Description Stone quarry right into the side of the river, used to build the church on the opposite side of the River.			
History:			
Significance: State and regional (Not because it is a quarry but because it is part of the group comprising the church, churchyard, and quarry).			
Alterations/Integrity:			
Condition: <input checked="" type="checkbox"/> Good <input type="checkbox"/> Fair <input type="checkbox"/> Poor	Style:	Street Context:	
Current Use: Nil Original use: Quarry	Period: <input checked="" type="checkbox"/> Pre-1890 <input type="checkbox"/> 1915-45 <input type="checkbox"/> 1890-1915 <input type="checkbox"/> 1945- Actual date (if known)	<input type="checkbox"/> Positive contribution <input type="checkbox"/> Neutral <input type="checkbox"/> Out of Character Possible remedies	
Current listings: <input type="checkbox"/> AHC <input type="checkbox"/> HC <input type="checkbox"/> NT <input type="checkbox"/> RAIA/Other			
Thematic context Industry and Churches and Cemeteries			
References: <u>Thematic History</u> : 91, 119			
*			

