

**Item name:** Munni

**Location:** 800 Salisbury Road Munni 2420

Dungog

**Address:** 800 Salisbury Road

**Planning:** Hunter & Central Coast

**Suburb/nearest town:** Munni 2420

**Local govt area:** Dungog

**State:** NSW

**Parish:**

**County:**

**Other/former names:**

**Area/group/complex:**

**Group ID:**

**Aboriginal area:**

**Curtilage/boundary:**

**Item type:** Built

**Group:** Residential buildings (private) **Category:** House

**Owner:** Private - Corporate

**Admin codes:**

**Code 2:**

**Code 3:**

**Current use:**

**Former uses:**

**Assessed significance:** State

**Endorsed significance:**

**Statement of significance:** The property, outbuildings and hut site are a record of the selection of this land by John Mann in 1828 and the occupation and farming of this land by the Mann family from 1828 until 1841. The outbuildings may be associated with John Mann's period of use of the land and this requires further investigation. Munni house is likely to have been built during William Alexander Smith's ownership and is a record of the occupation of the property by the the Smith family from 1873 until the purchase of the property by the Hunter Water Corporation. The period of use by Hunter Water from to the present day and the non-occupation of the house, leasing of the land and the current hiatus records a period of the proposed development of the Tillegra Dam and State Government's halt to the dam.

The Munni complex has aesthetic significance as a representative group that includes the homestead, corn shed, buggy shed, fences and gates, slaughter house and stockyards. The corn shed and buggy shed demonstrate a high degree of technical achievement in the carpentry work with hand hewn timbers. The slaughter house is a rare surviving example of this building type and the corn shed and buggy shed are a building type that is becoming increasingly rare. The Sunshine stamped steel gate is a rare surviving example of its type.

The property and buildings are valued by descendants of the Smith family and by the local community as a part of the rural history of the Dungog area and the Hunter Valley.

**Item name:** Munni**Location:** 800 Salisbury Road Munni 2420

Dungog

**Historical notes of provenance:** The history is extracted from the Tillegra Dam Planning and Environmental Assessment, Contemporary Heritage Working Paper 1.

John Mann migrated from England in 1828 and selected his land in November of that year calling it "Munni". His possession of land was approved in October 1829?, 1839? Mann was given 1,920 acres and erected a hut and fenced and stocked his land. In 1832 he applied and was given convict servants. John Mann's brother Samuel Furneaux was given ownership of the property in 1835 and both brothers are thought to have lived on the property until the c1841. "Local knowledge has indicated that a corn barn, stables and slaughter house had been built by this time." (pers comm. Philippa Smith Feb 2008).

Samuel Mann sold Munni to John Hughes in 1841. In 1843 it was transferred to Joseph Myatt and then to Edward Newton. In 1873 the property was transferred to the ownership of William Alexander Smith. Based on physical assessment of Munni by ERM the house may have been built during Alexander Smith's occupation in the late 1860s and early 1870s. In 1953 ownership was transferred to Edwin Fowler Smith and was then purchased from the Smith family by Hunter Water.

Dairying expanded in the 1890s and was developed further with the railway to Dungog. Refrigeration and electricity all helped the growth of the dairy industry. The population of Munni area increased in the 1920s with the improvement in technology in the dairy industry. The early farming included crops such as wheat, corn and tobacco. In the 1800s the main farming activity in the area included dairy and timber getting.

The property is currently owned by Hunter Water Corporation and was purchased for use as a part of the proposed Tillegra Dam.

**Themes:** National theme

- 2. Peopling
- 2. Peopling
- 3. Economy
- 3. Economy
- 4. Settlement
- 4. Settlement
- 9. Phases of Life

## State theme

- Aboriginal cultures and interactions with
- Convict
- Agriculture
- Agriculture
- Land tenure
- Utilities
- Persons

## Local theme

**Designer:****Builder:****Year started:****Year completed:****Circa:** No

**Item name:** Munni

**Location:** 800 Salisbury Road Munni 2420

Dungog

**Physical description:** Munni House is a brick construction made from hand bricks. The roof is clad with galvanised iron and is likely to have been a shingle roof originally. The verandahs were altered and widened in c1910. The house has additions to the south. It is described in detail in the Tillegra Dam Planning and Environmental Assessment, Contemporary Heritage Working Paper 1.

The outbuildings which include the corn shed and stables are described in detail in the Tillegra Dam Planning and Environmental Assessment, Contemporary Heritage Working Paper 1.

The slaughter house is a split slab structure dropped into slotted logs on the ground. Posts and roof structure are bush timbers with rafters hand chamfered at joint with ridge beam and posts shaped at base with log footings and with junction at roof. The structure is fixed with galvanised wire and nails and includes hand forged fixings on door and post. The roof is a gable structure open at each gable and clad with short sheets of galvanised iron. The floor is a concrete slab. A chain for tethering is located on the ridge beam.

Access to the interior was not possible as foundations have moved and the door is not movable. Photos were taken through opening in gables and slab walls.

The slaughter house is a small building for the butchering of one animal. It is attached to a cattle stockyard.

The stockyards are timber post and beam with a sappling as capping rail. Earlier members of the fence are hand split and shaped to fit into mortised joint. Later circular sawn timbers have been introduced and new galvanised gates.

**Physical condition level:**

**Physical condition:** House and outbuildings require maintenance and a caretaker presence. Slaughter house has active termites and foundation instability and requires maintenance and treatment and monitoring of termites. Vine should be poisoned and removed. The roof sheeting requires fixing.

**Archaeological potential level:**

**Archaeological potential Detail:**

**Modification dates:**

**Recommended management:**

**Management:** Management category

Management name

**Further comments:**

**Criteria a):** The property, outbuildings and hut site are a record of the selection of this land by John Mann in 1828 and the occupation and farming of this land by the Mann family from 1828 until 1841.  
**[Historical significance]**

Munni house is likely to have been built during William Alexander Smith's ownership and is a record of the occupation of the property by the the Smith family from 1873 until the purchase of the property by Hunter Water 2006? (date not recorded in ERM report).

The period of use by Hunter Water from to the present day and the non-occupation of the house, leasing of the land and the current hiatus records a period of the proposed development of the Tillegra Dam and State Government's halt to the dam.

**Item name:** Munni

**Location:** 800 Salisbury Road Munni 2420

Dungog

**Criteria b):** Munni, the property, outbuildings and hut site are associated with John Mann who was granted the land on which Munni is sited and occupied this land from 1828-1841. The outbuildings may be associated with John Mann's period of use of the land and this requires further investigation.

**[Historical association significance]**

The property is associated with William Alexander Smith and the house is likely to have been built during William Smith's ownership. The property is associated with generations of the Smith family from 1873 until the purchase of the property by Hunter Water in 2006?

Munni is associated with the Hunter Water Corporation ownership from 2006 to the present day and the period of the proposed development of the Tillegra Dam and the halt in development of the dam.

**Criteria c):** The Munni complex has aesthetic significance as a representative group that includes the homestead, corn shed, buggy shed, fences and gates, slaughter house and stockyards.

**[Aesthetic/Technical significance]** The corn shed and buggy shed demonstrate a high degree of technical achievement in the carpentry work with hand hewn timbers.

The stock yards adjoining the slaughter house includes some intact fencing with bush posts and hand hewn rails.

**Criteria d):** The property and buildings are valued by descendants of the Smith family and by the local community as a part of the rural history of the Dungog area and the Hunter Valley.

**[Social/Cultural significance]**

**Criteria e):** The outbuildings are technically accomplished examples of bush carpentry work and have the potential to provide further information on these building types. An Aboriginal grinding stone has been relocated in the vicinity of the corn shed. This and other artefacts may reveal further information about contact sites in this location and Aboriginal use of the land.

**[Research significance]**

**Criteria f):** The slaughter house is a rare surviving example of this building type.

**[Rarity]**

The corn shed and buggy shed are a building type is that is becoming increasingly rare.

The Sunshine stamped steel gate is a rare surviving example of its type.

**Criteria g):** The corn shed and buggy shed are representative of this building type in the accomplished bush carpentry.

**[Representative]**

**Intactness/Integrity:** The outbuildings including the corn store, buggy shed and slaughter house are intact. The house has been altered with additions though the earlier form is evident.

References:	Author	Title	Year
	Environmental Resources Management	Tillegra Dam Planning and Environmental Assessment Center	2008

Studies:	Author	Title	Number	Year
	Perumal, Wrathall & Murray	Dungog Heritage Study	R34	1986
	Carste Studio	Dungog Heritage Study Review	9	2013

Parcels:	Parcel code	Lot number	Section number	Plan code	Plan number
----------	-------------	------------	----------------	-----------	-------------

**Latitude:** 745265

**Longitude:**

**Location validity:**

**Spatial accuracy:**

**Map name:** Allynbrook

**Map scale:**

**AMG zone:**

**Easting:**

**Northing:**

**Item name:** Munni**Location:** 800 Salisbury Road Munni 2420

Dungog

**Listing:** Name**Title**

Local Environmental Plan

Heritage study

**Number****ListingDate**

06/04/1990

**Data entry:** Data first entered: 27/07/2001

Data updated: 19/11/2013

Status: Partial

**Item name:** Munni

**Location:** 800 Salisbury Road Munni 2420

Dungog

**Image:**

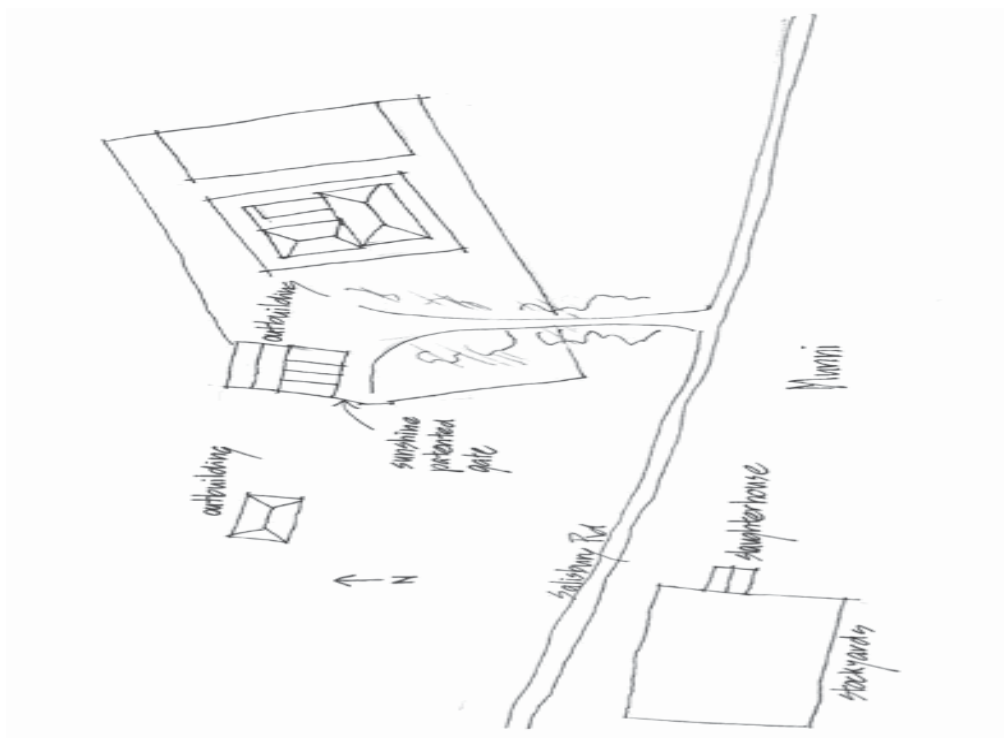

**Caption:** Munni

**Copy right:**

**Image by:** Carste Studio

**Image date:**

**Image number:**

**Image url:** <http://www.environment.nsw.gov.au/maritimeheritageapp/resources/Heritage/shi/WebAP/P/345f84ca43273774c8d97bc30a9e7ce1bd0.jpg>

**Thumbnail url:** [http://www.environment.nsw.gov.au/maritimeheritageapp/resources/Heritage/shi/WebAP/P/Thumb\\_test345f84ca43273774c8d97bc30a9e7ce1bd0.jpg](http://www.environment.nsw.gov.au/maritimeheritageapp/resources/Heritage/shi/WebAP/P/Thumb_test345f84ca43273774c8d97bc30a9e7ce1bd0.jpg)

**Item name:** Munni

**Location:** 800 Salisbury Road Munni 2420

Dungog

**Image:**



**Caption:** Munni

**Copy right:**

**Image by:** Carste Studio

**Image date:**

**Image number:**

**Image url:** <http://www.environment.nsw.gov.au/maritimeheritageapp/resources/Heritage/shi/WebAPP/345be69ad3aad9a422f9d6fb582d35f4151.JPG>

**Thumbnail url:** [http://www.environment.nsw.gov.au/maritimeheritageapp/resources/Heritage/shi/WebAPP/Thumb\\_test345be69ad3aad9a422f9d6fb582d35f4151.JPG](http://www.environment.nsw.gov.au/maritimeheritageapp/resources/Heritage/shi/WebAPP/Thumb_test345be69ad3aad9a422f9d6fb582d35f4151.JPG)



**Item name:** Munni

**Location:** 800 Salisbury Road Munni 2420

Dungog

**Image:**



**Caption:** Munni

**Copy right:**

**Image by:** Carste Studio

**Image date:**

**Image number:**

**Image url:** <http://www.environment.nsw.gov.au/maritimeheritageapp/resources/Heritage/shi/WebAPP/345e5cd4fd84a6f424289cb646aaab7f438.JPG>

**Thumbnail url:** [http://www.environment.nsw.gov.au/maritimeheritageapp/resources/Heritage/shi/WebAPP/Thumb\\_test345e5cd4fd84a6f424289cb646aaab7f438.JPG](http://www.environment.nsw.gov.au/maritimeheritageapp/resources/Heritage/shi/WebAPP/Thumb_test345e5cd4fd84a6f424289cb646aaab7f438.JPG)



**Item name:** Munni

**Location:** 800 Salisbury Road Munni 2420

Dungog

**Image:**



**Caption:** Munni

**Copy right:**

**Image by:** Carste Studio

**Image date:**

**Image number:**

**Image url:** <http://www.environment.nsw.gov.au/maritimeheritageapp/resources/Heritage/shi/WebAP/P/3450bc0034247d346b091eb2b44d10ab536.JPG>

**Thumbnail url:** [http://www.environment.nsw.gov.au/maritimeheritageapp/resources/Heritage/shi/WebAP/P/Thumb\\_test3450bc0034247d346b091eb2b44d10ab536.JPG](http://www.environment.nsw.gov.au/maritimeheritageapp/resources/Heritage/shi/WebAP/P/Thumb_test3450bc0034247d346b091eb2b44d10ab536.JPG)

**Item name:** Munni

**Location:** 800 Salisbury Road Munni 2420

Dungog

**Image:**



**Caption:** Munni

**Copy right:**

**Image by:** Carste Studio

**Image date:**

**Image number:**

**Image url:** <http://www.environment.nsw.gov.au/maritimeheritageapp/resources/Heritage/shi/WebAPP/345a5699d04b75a439a9f1ab4e9e5c7d366.JPG>

**Thumbnail url:** [http://www.environment.nsw.gov.au/maritimeheritageapp/resources/Heritage/shi/WebAPP/Thumb\\_test345a5699d04b75a439a9f1ab4e9e5c7d366.JPG](http://www.environment.nsw.gov.au/maritimeheritageapp/resources/Heritage/shi/WebAPP/Thumb_test345a5699d04b75a439a9f1ab4e9e5c7d366.JPG)

**Item name:** Munni

**Location:** 800 Salisbury Road Munni 2420

Dungog

**Image:**



**Caption:** Munni

**Copy right:**

**Image by:** Carste Studio

**Image date:**

**Image number:**

**Image url:** <http://www.environment.nsw.gov.au/maritimeheritageapp/resources/Heritage/shi/WebAP/P/345fef6ed6db6874e38b2b0f7615af27e4e.JPG>

**Thumbnail url:** [http://www.environment.nsw.gov.au/maritimeheritageapp/resources/Heritage/shi/WebAP/P/Thumb\\_test345fef6ed6db6874e38b2b0f7615af27e4e.JPG](http://www.environment.nsw.gov.au/maritimeheritageapp/resources/Heritage/shi/WebAP/P/Thumb_test345fef6ed6db6874e38b2b0f7615af27e4e.JPG)



**Item name:** Munni

**Location:** 800 Salisbury Road Munni 2420

Dungog

**Image:**



**Caption:** Munni

**Copy right:**

**Image by:** Carste Studio

**Image date:**

**Image number:**

**Image url:** <http://www.environment.nsw.gov.au/maritimeheritageapp/resources/Heritage/shi/WebAPP/345eca2f5a6014b4461be10d031afa42b32.JPG>

**Thumbnail url:** [http://www.environment.nsw.gov.au/maritimeheritageapp/resources/Heritage/shi/WebAPP/Thumb\\_test345eca2f5a6014b4461be10d031afa42b32.JPG](http://www.environment.nsw.gov.au/maritimeheritageapp/resources/Heritage/shi/WebAPP/Thumb_test345eca2f5a6014b4461be10d031afa42b32.JPG)

**Item name:** Munni

**Location:** 800 Salisbury Road Munni 2420

Dungog

**Image:**



**Caption:** Munni

**Copy right:**

**Image by:** Carste Studio

**Image date:**

**Image number:**

**Image url:** <http://www.environment.nsw.gov.au/maritimeheritageapp/resources/Heritage/shi/WebAP/P/3454ab7eb69dcdf4f789f03df116df42530.JPG>

**Thumbnail url:** [http://www.environment.nsw.gov.au/maritimeheritageapp/resources/Heritage/shi/WebAP/P/Thumb\\_test3454ab7eb69dcdf4f789f03df116df42530.JPG](http://www.environment.nsw.gov.au/maritimeheritageapp/resources/Heritage/shi/WebAP/P/Thumb_test3454ab7eb69dcdf4f789f03df116df42530.JPG)

**Item name:** Munni

**Location:** 800 Salisbury Road Munni 2420

Dungog

**Image:**



**Caption:** Munni

**Copy right:**

**Image by:** Carste Studio

**Image date:**

**Image number:**

**Image url:** <http://www.environment.nsw.gov.au/maritimeheritageapp/resources/Heritage/shi/WebAPP/345dcc89009abdd48f39563b5ed996cc873.JPG>

**Thumbnail url:** [http://www.environment.nsw.gov.au/maritimeheritageapp/resources/Heritage/shi/WebAPP/Thumb\\_test345dcc89009abdd48f39563b5ed996cc873.JPG](http://www.environment.nsw.gov.au/maritimeheritageapp/resources/Heritage/shi/WebAPP/Thumb_test345dcc89009abdd48f39563b5ed996cc873.JPG)



**Item name:** Munni

**Location:** 800 Salisbury Road Munni 2420

Dungog

**Image:**



**Caption:** Munni

**Copy right:**

**Image by:** Carste Studio

**Image date:**

**Image number:**

**Image url:** <http://www.environment.nsw.gov.au/maritimeheritageapp/resources/Heritage/shi/WebAPP/345d6b482e2f576465d80ff8e5a12a54338.JPG>

**Thumbnail url:** [http://www.environment.nsw.gov.au/maritimeheritageapp/resources/Heritage/shi/WebAPP/Thumb\\_test345d6b482e2f576465d80ff8e5a12a54338.JPG](http://www.environment.nsw.gov.au/maritimeheritageapp/resources/Heritage/shi/WebAPP/Thumb_test345d6b482e2f576465d80ff8e5a12a54338.JPG)



**Item name:** Munni

**Location:** 800 Salisbury Road Munni 2420

Dungog

**Image:**



**Caption:** Munni

**Copy right:**

**Image by:** Carste Studio

**Image date:**

**Image number:**

**Image url:** <http://www.environment.nsw.gov.au/maritimeheritageapp/resources/Heritage/shi/WebAPP/34509182c9a116a431dbd4f0fddf6b2ce82.JPG>

**Thumbnail url:** [http://www.environment.nsw.gov.au/maritimeheritageapp/resources/Heritage/shi/WebAPP/Thumb\\_test34509182c9a116a431dbd4f0fddf6b2ce82.JPG](http://www.environment.nsw.gov.au/maritimeheritageapp/resources/Heritage/shi/WebAPP/Thumb_test34509182c9a116a431dbd4f0fddf6b2ce82.JPG)

**Item name:** Munni

**Location:** 800 Salisbury Road Munni 2420

Dungog

**Image:**



**Caption:** Munni

**Copy right:**

**Image by:** Carste Studio

**Image date:**

**Image number:**

**Image url:** <http://www.environment.nsw.gov.au/maritimeheritageapp/resources/Heritage/shi/WebAPP/3453f64c23d95dc41818e616b457c00a1ac.JPG>

**Thumbnail url:** [http://www.environment.nsw.gov.au/maritimeheritageapp/resources/Heritage/shi/WebAPP/Thumb\\_test3453f64c23d95dc41818e616b457c00a1ac.JPG](http://www.environment.nsw.gov.au/maritimeheritageapp/resources/Heritage/shi/WebAPP/Thumb_test3453f64c23d95dc41818e616b457c00a1ac.JPG)

**Item name:** Munni

**Location:** 800 Salisbury Road Munni 2420

Dungog

**Image:**



**Caption:** Munni

**Copy right:**

**Image by:** Carste Studio

**Image date:**

**Image number:**

**Image url:** <http://www.environment.nsw.gov.au/maritimeheritageapp/resources/Heritage/shi/WebAPP/34553336e6c7e834aa288525ca9d0aeef19.JPG>

**Thumbnail url:** [http://www.environment.nsw.gov.au/maritimeheritageapp/resources/Heritage/shi/WebAPP/Thumb\\_test34553336e6c7e834aa288525ca9d0aeef19.JPG](http://www.environment.nsw.gov.au/maritimeheritageapp/resources/Heritage/shi/WebAPP/Thumb_test34553336e6c7e834aa288525ca9d0aeef19.JPG)



**Item name:** Munni

**Location:** 800 Salisbury Road Munni 2420

Dungog

**Image:**



**Caption:** Munni

**Copy right:**

**Image by:** Carste Studio

**Image date:**

**Image number:**

**Image url:** <http://www.environment.nsw.gov.au/maritimeheritageapp/resources/Heritage/shi/WebAPP/345ce6712ca644146229d40e1ca9eb18e07.JPG>

**Thumbnail url:** [http://www.environment.nsw.gov.au/maritimeheritageapp/resources/Heritage/shi/WebAPP/Thumb\\_test345ce6712ca644146229d40e1ca9eb18e07.JPG](http://www.environment.nsw.gov.au/maritimeheritageapp/resources/Heritage/shi/WebAPP/Thumb_test345ce6712ca644146229d40e1ca9eb18e07.JPG)

**Item name:** Munni

**Location:** 800 Salisbury Road Munni 2420

Dungog

**Image:**



**Caption:** Munni

**Copy right:**

**Image by:** Carste Studio

**Image date:**

**Image number:**

**Image url:** <http://www.environment.nsw.gov.au/maritimeheritageapp/resources/Heritage/shi/WebAPP/3450cc8c496f2e1494e8fc62ca4d7d5c5f4.JPG>

**Thumbnail url:** [http://www.environment.nsw.gov.au/maritimeheritageapp/resources/Heritage/shi/WebAPP/Thumb\\_test3450cc8c496f2e1494e8fc62ca4d7d5c5f4.JPG](http://www.environment.nsw.gov.au/maritimeheritageapp/resources/Heritage/shi/WebAPP/Thumb_test3450cc8c496f2e1494e8fc62ca4d7d5c5f4.JPG)

**Item name:** Munni

**Location:** 800 Salisbury Road Munni 2420

Dungog

**Image:**



**Caption:** Munni

**Copy right:**

**Image by:** Carste Studio

**Image date:**

**Image number:**

**Image url:** <http://www.environment.nsw.gov.au/maritimeheritageapp/resources/Heritage/shi/WebAPP/3452af3244d1f7b425f893d00361f22d141.JPG>

**Thumbnail url:** [http://www.environment.nsw.gov.au/maritimeheritageapp/resources/Heritage/shi/WebAPP/Thumb\\_test3452af3244d1f7b425f893d00361f22d141.JPG](http://www.environment.nsw.gov.au/maritimeheritageapp/resources/Heritage/shi/WebAPP/Thumb_test3452af3244d1f7b425f893d00361f22d141.JPG)



**Item name:** Munni

**Location:** 800 Salisbury Road Munni 2420

Dungog

**Image:**



**Caption:** Munni

**Copy right:**

**Image by:** Carste Studio

**Image date:**

**Image number:**

**Image url:** <http://www.environment.nsw.gov.au/maritimeheritageapp/resources/Heritage/shi/WebAPP/34575668c11ecc94f779073fe96b0c81a3e.JPG>

**Thumbnail url:** [http://www.environment.nsw.gov.au/maritimeheritageapp/resources/Heritage/shi/WebAPP/Thumb\\_test34575668c11ecc94f779073fe96b0c81a3e.JPG](http://www.environment.nsw.gov.au/maritimeheritageapp/resources/Heritage/shi/WebAPP/Thumb_test34575668c11ecc94f779073fe96b0c81a3e.JPG)



**Item name:** Munni

**Location:** 800 Salisbury Road Munni 2420

Dungog

**Image:**



**Caption:** Munni

**Copy right:**

**Image by:** Carste Studio

**Image date:**

**Image number:**

**Image url:** <http://www.environment.nsw.gov.au/maritimeheritageapp/resources/Heritage/shi/WebAPP/345fbad499435574564bc849a97fb83c2fa.JPG>

**Thumbnail url:** [http://www.environment.nsw.gov.au/maritimeheritageapp/resources/Heritage/shi/WebAPP/Thumb\\_test345fbad499435574564bc849a97fb83c2fa.JPG](http://www.environment.nsw.gov.au/maritimeheritageapp/resources/Heritage/shi/WebAPP/Thumb_test345fbad499435574564bc849a97fb83c2fa.JPG)

**Item name:** Munni

**Location:** 800 Salisbury Road Munni 2420

Dungog

**Image:**



**Caption:** Munni

**Copy right:**

**Image by:** Carste Studio

**Image date:**

**Image number:**

**Image url:** <http://www.environment.nsw.gov.au/maritimeheritageapp/resources/Heritage/shi/WebAPP/345a66ca68a09b840c099fd7eb9e67edddf.JPG>

**Thumbnail url:** [http://www.environment.nsw.gov.au/maritimeheritageapp/resources/Heritage/shi/WebAPP/Thumb\\_test345a66ca68a09b840c099fd7eb9e67edddf.JPG](http://www.environment.nsw.gov.au/maritimeheritageapp/resources/Heritage/shi/WebAPP/Thumb_test345a66ca68a09b840c099fd7eb9e67edddf.JPG)

**Item name:** Munni

**Location:** 800 Salisbury Road Munni 2420

Dungog

**Image:**



**Caption:** Munni

**Copy right:**

**Image by:** Carste Studio

**Image date:**

**Image number:**

**Image url:** <http://www.environment.nsw.gov.au/maritimeheritageapp/resources/Heritage/shi/WebAPP/3452ad448058bfd42589c8d7de671aca3d7.JPG>

**Thumbnail url:** [http://www.environment.nsw.gov.au/maritimeheritageapp/resources/Heritage/shi/WebAPP/Thumb\\_test3452ad448058bfd42589c8d7de671aca3d7.JPG](http://www.environment.nsw.gov.au/maritimeheritageapp/resources/Heritage/shi/WebAPP/Thumb_test3452ad448058bfd42589c8d7de671aca3d7.JPG)



**Item name:** Munni

**Location:** 800 Salisbury Road Munni 2420

Dungog

**Image:**



**Caption:** Munni

**Copy right:**

**Image by:** Carste Studio

**Image date:**

**Image number:**

**Image url:** <http://www.environment.nsw.gov.au/maritimeheritageapp/resources/Heritage/shi/WebAPP/345a68fa52f54d144b1ac213b3f12ee292e.JPG>

**Thumbnail url:** [http://www.environment.nsw.gov.au/maritimeheritageapp/resources/Heritage/shi/WebAPP/Thumb\\_test345a68fa52f54d144b1ac213b3f12ee292e.JPG](http://www.environment.nsw.gov.au/maritimeheritageapp/resources/Heritage/shi/WebAPP/Thumb_test345a68fa52f54d144b1ac213b3f12ee292e.JPG)

**Item name:** Munni

**Location:** 800 Salisbury Road Munni 2420

Dungog

**Image:**



**Caption:** Munni

**Copy right:**

**Image by:** Carste Studio

**Image date:**

**Image number:**

**Image url:** <http://www.environment.nsw.gov.au/maritimeheritageapp/resources/Heritage/shi/WebAP/P/345611ac1e97a18429aa9a3ec8d8c1a41ae.JPG>

**Thumbnail url:** [http://www.environment.nsw.gov.au/maritimeheritageapp/resources/Heritage/shi/WebAP/P/Thumb\\_test345611ac1e97a18429aa9a3ec8d8c1a41ae.JPG](http://www.environment.nsw.gov.au/maritimeheritageapp/resources/Heritage/shi/WebAP/P/Thumb_test345611ac1e97a18429aa9a3ec8d8c1a41ae.JPG)